

FlexPoint™ Powered Chassis

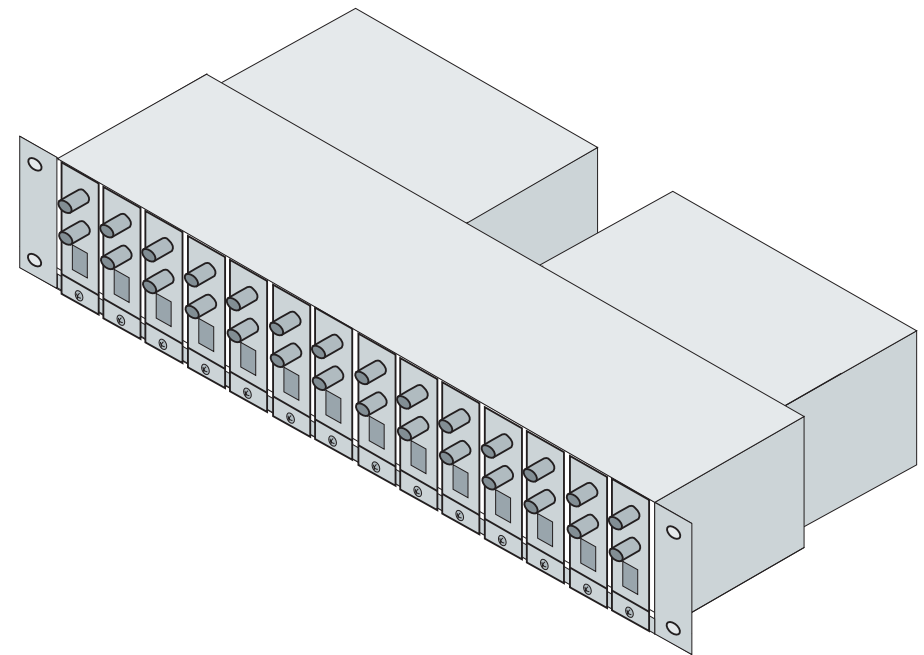

TRADEMARKS

All applied-for and registered trademarks are the property of their respective owners.

FEDERAL COMMUNICATIONS COMMISSION AND CANADIAN DEPARTMENT OF COMMUNICATIONS RADIO FREQUENCY INTERFERENCE STATEMENTS

This equipment generates, uses, and can radiate radio frequency energy and if not installed and used properly, that is, in strict accordance with the manufacturer's instructions, may cause interference to radio communication. It has been tested and found to comply with the limits for a Class A computing device in accordance with the specifications in subpart J of Part 15 of FCC rules, which are designed to provide reasonable protection against such interference when the equipment is operated in a commercial environment. Operation of this equipment in a residential area is likely to cause interference, in which case the user at his own expense will be required to take whatever measures may be necessary to correct the interference.

Changes or modifications not expressly approved by the party responsible for compliance could void the user's authority to operate the equipment.

This digital apparatus does not exceed the Class A limits for radio noise emission from digital apparatus set out in the Radio Interference Regulation of the Canadian Department of Communications.

Le présent appareil numérique n'émet pas de bruits radioélectriques dépassant les limites applicables aux appareils numériques de la classe A prescrites dans le Règlement sur le brouillage radioélectrique publié par le ministère des Communications du Canada.

HOT REMOVAL OF POWER SUPPLY:

1. Determine which one is the faulty power supply by observing the LEDs in the front left of the chassis: the top LED indicates the power status of the right power supply, the bottom LED indicates the power status of the left power supply.
Notice that LED being ON indicates that the power supply is operational. The LED being OFF may indicate that the AC power is not applied, please verify that your AC power source is providing power.
2. Once you determine that your AC plug is connected properly to an AC wall outlet, and the power supply LED is still not ON, determine which is the failing power supply unit and proceed to the next step.
3. Remove the AC power cord of the faulty power supply from the wall outlet.
4. Remove the AC power cord of the faulty power supply from the power supply unit.
5. Loosen the 2 screws securing the power supply to the main chassis (observe the illustration).
6. Remove the failing power supply.

HOT ATTACHMENT OF POWER SUPPLY:

1. Unpack the power supply carefully. Inspect for any damages. If any damage is observed, do not use the power supply, instead, report the damage immediately and request a replacement unit.
2. Align the guide pins of the chassis with the holes in the power supply; tighten the screws with a flat head screw driver.
3. Plug the AC cord to the back of the power supply.
4. Plug the AC cord to the AC wall outlet.
5. Watch and listen to the fan in the rear of the power supply start to run.
6. Watch and observe the LED in the front of the chassis indicating that the power has been restored.
7. Save the packing material of the power supply for shipment of the faulty power supply or for future reuse.

SPECIFICATION

■ Dimensions/Weight:

LMC200	W:19.0"xD:7.0"xH:3.5" / 9 lb.
LMC200-2PS	W:19.0"xD:7.0"xH:3.5" / 12 lb.
PSFP200	W:8.0"xD:3.0"xH:3.5" / 3 lb.

- ### ■ Power:
- Two line outlets: 110 VAC / 3.0 Amps / 60 Hz each or
Two line outlets: 230 VAC / 1.5 Amps / 50 Hz each

■ Environmental:

Temperature:	0 to 40 degrees C
Humidity:	0-90% (non-condensing)

NORMAS OFICIALES MEXICANAS (NOM)
ELECTRICAL SAFETY STATEMENT

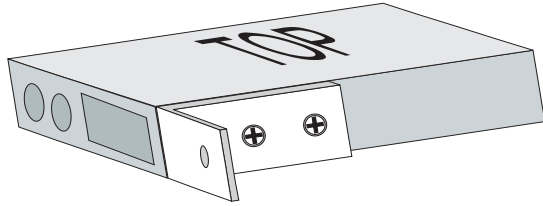

c. Save the unused tabs in a safe place or secure them to the chassis' unused slots.

POWER SUPPLY REPLACEMENT

WARNING

NEVER ATTEMPT TO OPEN OR SERVICE THE POWER SUPPLY UNIT. OPENING THE POWER SUPPLY UNIT MAY CAUSE SERIOUS INJURY OR DEATH.

The PowerChassis is intended to be used with two power supplies in a power-redundant operation. A failure of a single supply should not disturb the operation of the chassis unit. However, certain power supply failures may cause a secondary failure to the associated fan and cause undesired overheating of the chassis unit.

It is strongly recommended that a replacement power supply unit be installed as soon as possible in order to prevent overheating of the chassis unit.

THE POWER SUPPLIES ARE HOT SWAPPABLE AND CAN BE REPLACED WITHOUT SHUTTING THE NETWORK DOWN. HOWEVER, WHEN REMOVING AND REPLACING A POWER SUPPLY UNIT, THE FOLLOWING STEPS MUST BE STRICTLY FOLLOWED IN ORDER TO PREVENT SERIOUS INJURY OR DEATH, OR SERIOUS DAMAGE TO YOUR EQUIPMENT.

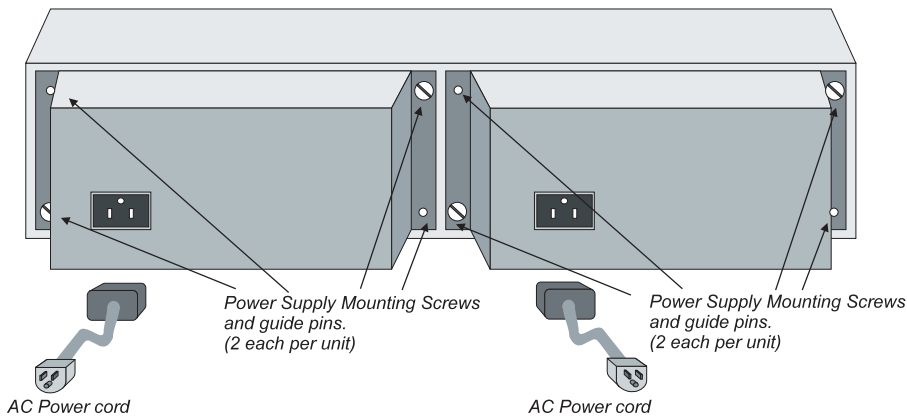

1. Todas las instrucciones de seguridad y operación deberán ser leídas antes de que el aparato eléctrico sea operado.
2. Las instrucciones de seguridad y operación deberán ser guardadas para referencia futura.
3. Todas las advertencias en el aparato eléctrico y en sus instrucciones de operación deben ser respetadas.
4. Todas las instrucciones de operación y uso deben ser seguidas.
5. El aparato eléctrico no deberá ser usado cerca del agua—por ejemplo, cerca de la tina de baño, lavabo, sótano mojado o cerca de una alberca, etc.
6. El aparato eléctrico debe ser usado únicamente con carritos o pedelstales que sean recomendados por el fabricante.
7. El aparato eléctrico debe ser montado a la pared o al techo sólo como sea recomendado por el fabricante.
8. Servicio—El usuario no debe intentar dar servicio al equipo eléctrico más allá a lo descrito en las instrucciones de operación. Todo otro servicio deberá ser referido a personal de servicio calificado.
9. El aparato eléctrico debe ser situado de tal manera que su posición no interfiera su uso. La colocación del aparato eléctrico sobre una cama, sofá, alfombra or superficie similar puede bloquea la ventilación, no se debe colocar en libreros o gabinetes que impidan el flujo de aire por los orificios de ventilación.
10. El equipo eléctrico deber ser situado fuera del alcance de fuentes de calor como radiadores, registros de calor, estufas u otros aparatos (incluyendo amplificadores) que producen calor.
11. El aparato eléctrico deberá ser conectado a una fuente de poder sólo del tipo descrito en el instructivo de operación, o como se indique en el aparato.
12. Precación debe ser tomada de tal manera que la tierra física y la polarización del equipo no sea eliminada.
13. Los cables de la fuente de poder deben ser guiados de tal manera que no sean pisados ni pellizcados por objetos colocados sobre o contra ellos, poniendo particular atención a los contactos y receptáculos donde salen del aparato.
14. El equipo eléctrico debe ser limpiado únicamente de acuerdo a las recomendaciones del fabricante.
15. En caso de existir, una antena externa deberá ser localizada lejos de las líneas de energía.
16. El cable de corriente deberá ser desconectado del cuando el equipo no sea usado por un largo periodo de tiempo.
17. Cuidado debe ser tomado de tal manera que objetos líquidos no sean derramados sobre la cubierta u orificios de ventilación.
18. Servicio por personal calificado deberá ser provisto cuando:
 - A: El cable de poder o el contacto ha sido dañado; u
 - B: Objetos han caído o líquido ha sido derramado dentro del aparato; o
 - C: El aparato ha sido expuesto a la lluvia; o
 - D: El aparato parece no operar normalmente o muestra un cambio en su desempeño; o
 - E: El aparato ha sido tirado o su cubierta ha sido dañada.

FlexPoint™ Powered Chassis User's Manual

GENERAL DESCRIPTION

The FlexPoint Powered Chassis is capable of holding up to 14 FlexPoint™ media converter modules. It is equipped with two power supplies in a power-redundant configuration. This manual describes the following models:

<u>Model</u>	<u>Description</u>
LMC200	FlexPoint Powered Chassis with 1 Power Supply
LMC200-2PS	FlexPoint Powered Chassis with 2 Power Supplies
PSFP200	Redundant power supply for FlexPoint Powered Chassis

CONTROLS AND INDICATORS

LEDs Display

The FlexPoint Powered Chassis features two LEDs on the left front of the chassis, these LEDs display the status of the two power supplies.

<u>Function</u>	<u>Color/State</u>	<u>Description</u>
Top LED	Yellow / ON	Power OK in right power supply
Bottom LED	Yellow / ON	Power OK in left power supply

Note that the left/right directions are as viewed from the front of the chassis. Also note that when a power supply is removed, its LED may show a dim light, this is normal.

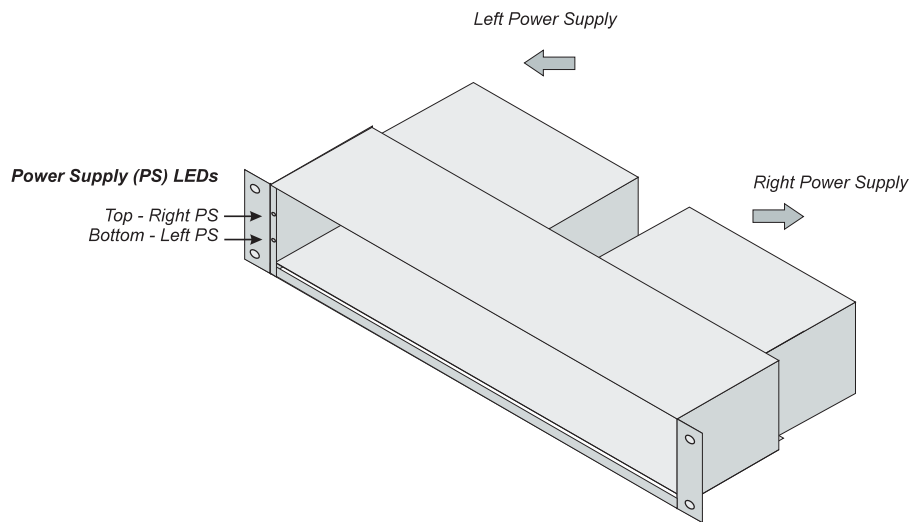

INSTALLATION

SITE PREPARATION REQUIREMENTS

1. Power: Two power outlets should be available within 5 feet of the unit.
2. The operating temperature of this equipment is 0-40 degrees C. If installed in a closed or multi-unit rack assembly, the operating ambient temperature of the rack must not exceed the maximum rated 40 degrees C temperature.
3. Installation of the equipment should be such that the air flow in the front and back of the unit is not compromised or restricted.
4. Never use this equipment to carry any weight except its own, never use it as a shelf to support weight of other equipment.
5. Installing this equipment into a rack in such a way as to make it unstable may cause injury or death. Always make sure that the rack you are installing this equipment into is properly secure, stable, balanced and designed to carry the weight and weight distribution of this equipment.
6. When rack-mounting this equipment, the rack should be appropriately earth-grounded.
7. This equipment requires 110 VAC / 1.5 Amps at 60 Hz (or 220 VAC / .75 Amps at 50 Hz) power per outlet (two outlets are required) to a combined total of 110 VAC / 3.0 Amps at 60 Hz (or 220 VAC / 1.5 Amp at 50 Hz). Appropriate overloading protection should be provided on all AC power source outlets utilized.

UNPACKING and INVENTORY

Visual Inspection - Inspect equipment in order to detect any physical damage. Review contents, the following items should be included for the different models:

<u>Description</u>	<u>LMC200</u>	<u>LMC200-2PS</u>	<u>PSFP200</u>
FlexPoint Powered Chassis chassis unit.	1	1	
Power supplies (attached)	1	2	1
Power cords	1	2	1
"L" shape tabs	14	14	
Screws for tabs	14	14	
User's manual (this document)	1	1	1

Any evidence of damage or any missing items should be noted and reported immediately.

CONNECTING POWER CABLES and POWER-UP

- a. Plug the two power cords into two appropriate AC wall outlets. The two LED power lights should turn ON.
- b. Attach the L shaped tabs to the FlexPoint units to be inserted into the chassis, Secure the FlexPoint module using the enclosed screws.